

Ex. front 39.55  
Footage 34.00

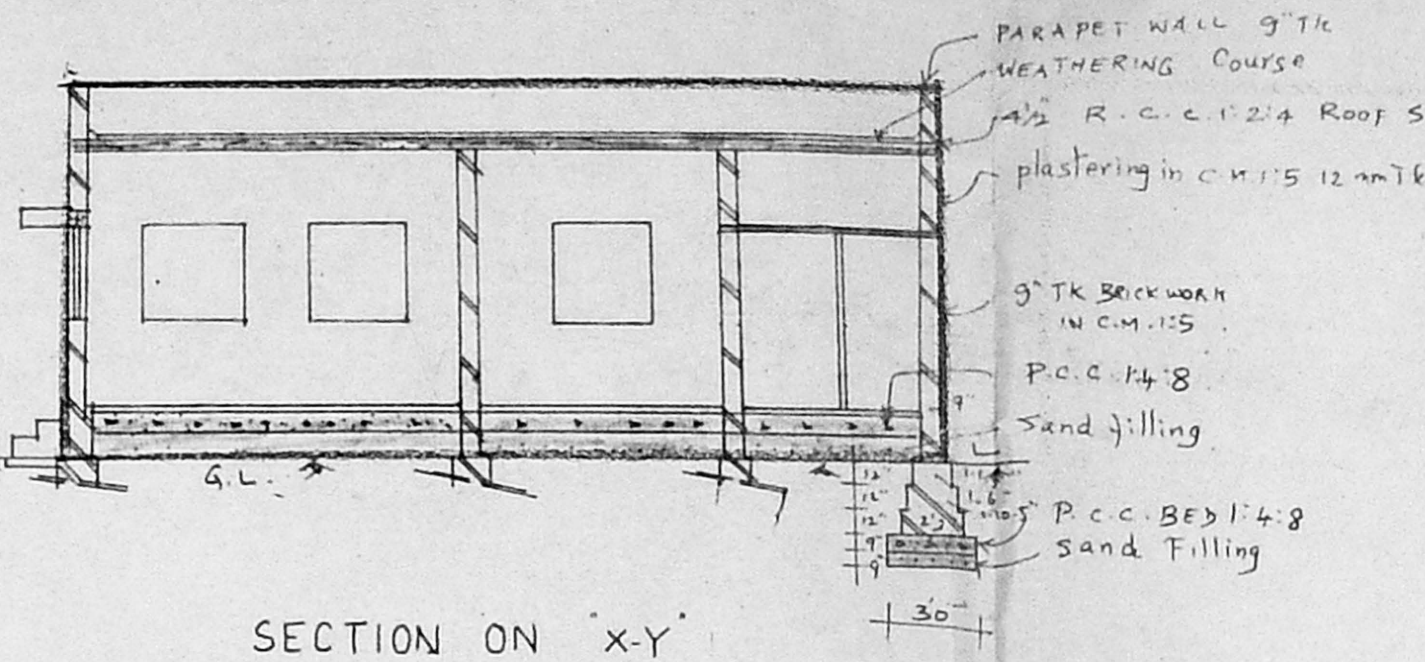
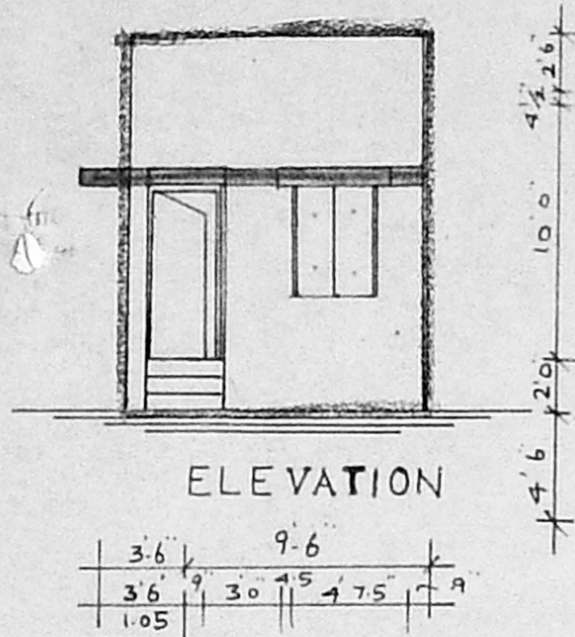

SCHEDULE OF JOINERIES.

D - DOOR	3'0" x 6'6"
D <sub>2</sub> DOOR	2'6" x 6'6"
W WINDOW	4'6" x 4'6"
W <sub>1</sub> "	3'0" x 4'6"
V ventilator	3'0" x 2'0"

A<sub>2</sub>/5156/95  
20/5/95

COLOUR INDEX

PROPOSED ROADS	
SITE BOUNDARY	

AREA DETAILS

PLOT AREA	585 sq.ft.
PLINTH AREA	332.50 "

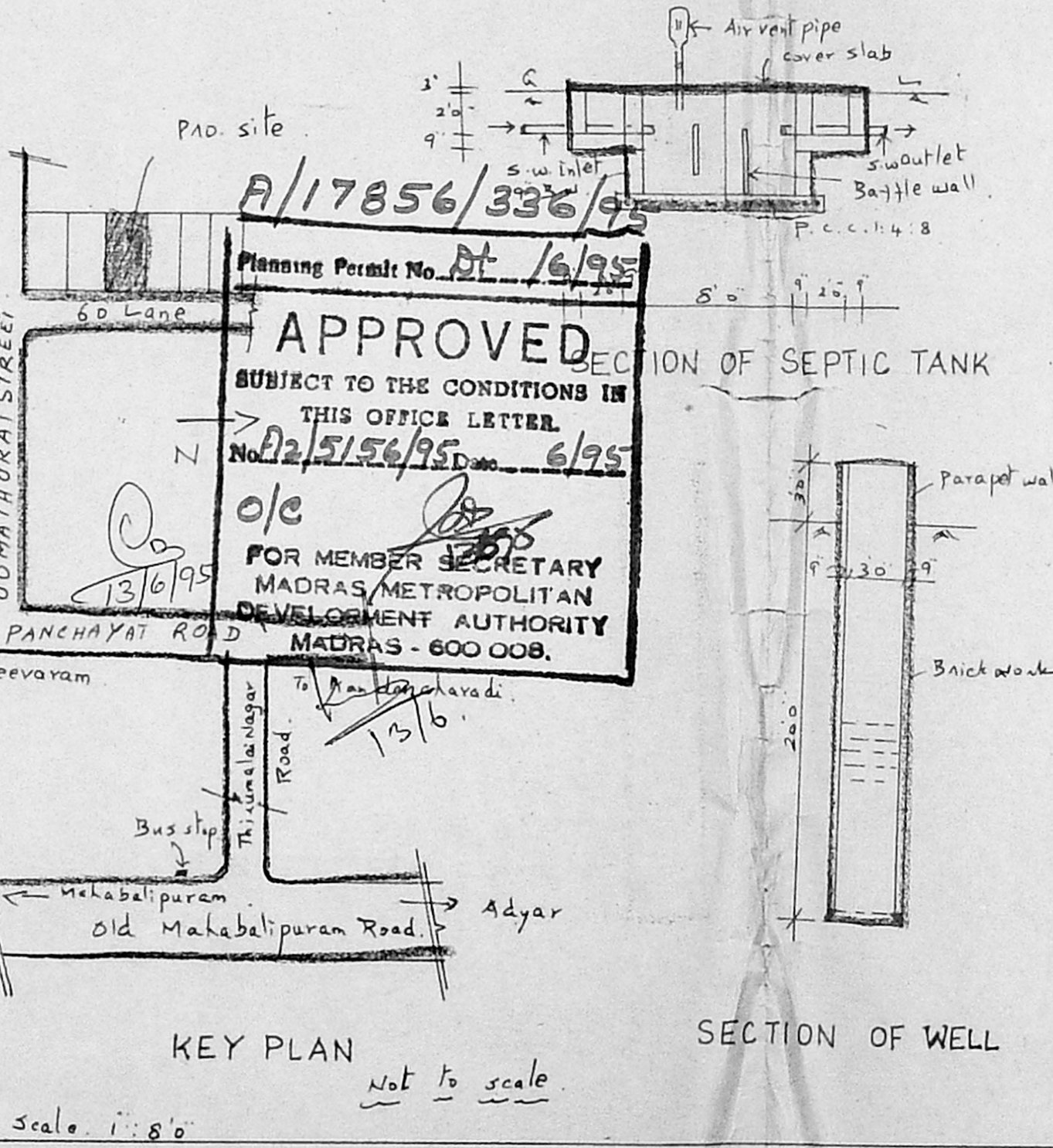
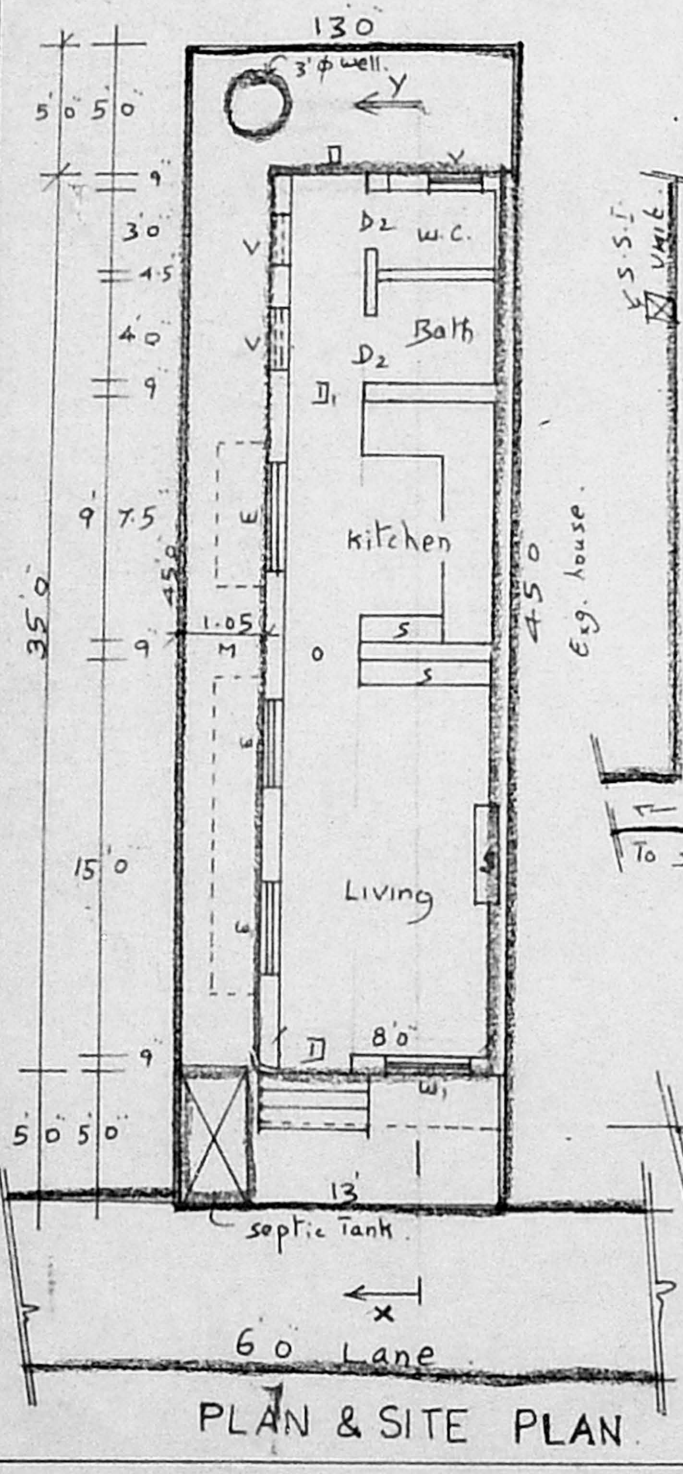

A/17856/336/95  
Planning Permit No. Dt. 16/95  
**APPROVED**  
SUBJECT TO THE CONDITIONS IN THIS OFFICE LETTER.  
No. A/2/5156/95 Dt. 6/95  
o/c  
FOR MEMBER SECRETARY  
MADRAS METROPOLITAN  
DEVELOPMENT AUTHORITY  
MADRAS - 600 008.

PLAN OF PROPOSED DWELLING HOUSE AT SURVEY NO. 96 OF PERUNGUDI VILLAGE, SAIDAPET TALUK, CHENGALPATTU MGR DISTRICT FOR MR S. PARAMASIVAN SCALE 1" : 8'0" (1:100)

OWNER SIGNATURE 15.2.95

J.S. ARIVAZHAGAN, D.C.E.,  
Licensed Surveyor,  
PERUNGUDI TOWN PANCHAYAT,  
Consulting Engineer & Contractor  
Res. No. 6, Thirumalai Nagar,  
PERUNGUDI, MADRAS-96.

LICENSED SURVEYOR.